



LIVE MORE



SOUTHWINDS

'LIVE MORE'

Live more: **live in Southwinds**

Give wings to your imagination. Take a flight to the fantasy world. A world that is not just a manifestation of your dreams, but a figment of your fancies. Love, joy, belongings. Everything is in abundance. Peace is all pervading. Harmony is all encompassing.

And access to it is uninhibited. Unrestricted. Behold! Fairy tales do come true.

- Spread over 630 Cottahs of land
- 1326 Apartments
- 10 Blocks
- G+11





LEGEND FOR PROPOSED FACILITIES IN LANDSCAPE AREAS :

- |  |                                      |
|--|--------------------------------------|
| 1 ENTRY/EXIT GATE                          | 15 MINI CRICKET                      |
| 2 LINEAR WATER FEATURES                    | 16 SPACE FOR PUJA (11.5mx7.0m)       |
| 3 PLANTERS WITH ORNAMENTAL FLOWERING TREES | 17 WATER SPOUTS (07 NOS.)            |
| 4 SITTING AREA                             | 18 MAIN SWIMMING POOL                |
| 5 PLANTER WALL-CUM-SEAT                    | 19 KIDS POOL                         |
| 6 CHILDREN PLAY AREA                       | 20 JACUZZI                           |
| 7 SCULPTURE                                | 21 SWIMMING POOL DECK                |
| 8 GRASS JOINTED PAVEMENT                   | 22 LAWN AREA FOR COMMUNITY FUNCTIONS |
| 9 LANDSCAPED GREEN WITH ADDA ZONE          | 23 DROP-OFF AREA                     |
| 10 GAZEBO WITH SEATS                       | 24 WATER FEATURE                     |
| 11 SITTING TIERS                           | 25 SEATS                             |
| 12 NATURAL POND WITH FLOATING FOUNTAIN     | 26 PATHWAY                           |
| 13 HALF BASKETBALL COURT                   | 27 PERGOLA                           |
| 14 BADMINTON COURT                         |                                      |

LANDSCAPE MATERIALS LEGEND:

HARD LANDSCAPE:

LEGEND DESCRIPTION

- |                                  |                            |
|----------------------------------|----------------------------|
| RESIDENTIAL TOWERS               | GRASS JOINTED PAVEMENT     |
| COMMERCIAL                       | PATHWAY IN STEPPING STONES |
| OPEN TERRACES                    | GAZEBOS                    |
| PERIPHERAL ROAD                  | SCULPTURES                 |
| ACCENT PAVING AT THE ENTRIES     | ENTRY/EXIT POINTS          |
| PEDESTRIAN PATHWAYS              | SEATS                      |
| CAR PARKING BAYS IN GRASS PAVERS |                            |

SOFT LANDSCAPE:

LEGEND DESCRIPTION

- |                                    |
|------------------------------------|
| ORNAMENTAL/FLOWERING FOLIAGE TREES |
| PALM TREES                         |
| PLANTING BED/PLANTER               |
| LAWN                               |





## Location



## Live more: live comfortable

The constant car honks. The dust. The never ending traffic. The useless rush on streets. Sounds familiar. Isn't it. Almost a way of today's life. You would say.

Time to change your way, we say.

Southwinds is located right in the lap of nature. Full of sunshine and fresh air. Stay cocooned. Not between cement and noisy roads. But lush greens and clear blues.

- Conveniently located on the southern bypass
- Dust and pollution free zone
- Metro Connectivity

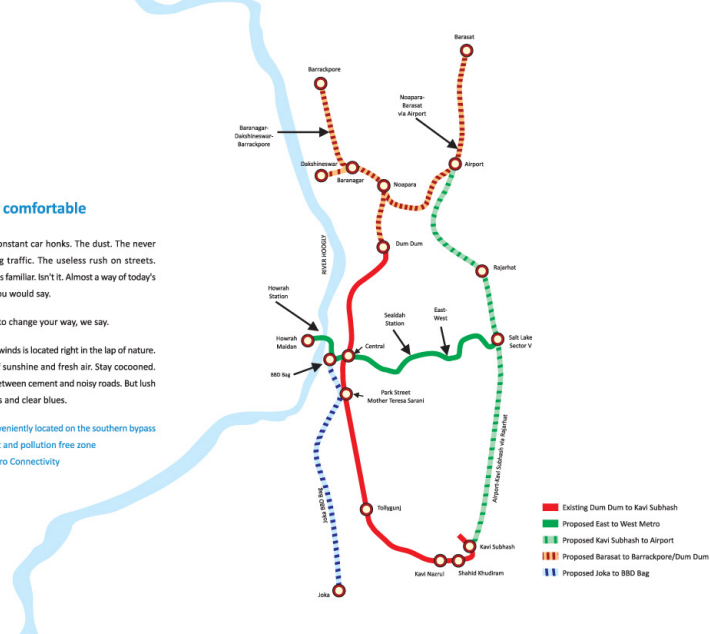

### Live more: **live green**

Close your eyes. Allow the morning breeze to give you a positive start. Let the afternoon sun bathe you in her glow and warmth. Talk to the winds. They will tell you stories of fresh and calm. Indulge.

- More than 50% green area
- Tranquil environment
- Central landscaped garden





### Live more: **live stress-free**

Think of your child when he was two years old. That million dollar smile of his meant the world to you. Now think of the child in you. Can't locate? He is hiding behind worldly wisdom. Gently hold his hands and bring him out. Laugh out aloud. Share memories. Some gossip is also not bad. Softer! The birds are listening.

- Walking trail
- Acupressure pathway
- Children's play area
- Multipurpose courts
- Badminton and basketball







### Live more: **live stress-free**

Think of your child when he was two years old. That million dollar smile of his meant the world to you. Now think of the child in you. Can't locate? He is hiding behind worldly wisdom. Gently hold his hands and bring him out. Laugh out aloud. Share memories. Some gossip is also not bad. Softer! The birds are listening.

- Walking trail
- Acupressure pathway
- Children's play area
- Multipurpose courts
- Badminton and basketball





### Live more: **live stress-free**

Think of your child when he was two years old. That million dollar smile of his meant the world to you. Now think of the child in you. Can't locate? He is hiding behind worldly wisdom. Gently hold his hands and bring him out. Laugh out aloud. Share memories. Some gossip is also not bad. Softer! The birds are listening.

- Walking trail
- Acupressure pathway
- Children's play area
- Multipurpose courts
- Badminton and basketball





Live more: **live spirited**

A splash. A spatter. Even a drop of this leaves you so feeling so energized. And when you are left all to yourself in a pool of cool blue! Play, sleep, float. The depths and vigour await you.

- Swimming pool
- Kid's pool
- Natural pond



Live more: live luxury

Catch up with friends. Unwind. Watch a Nirupa Roy film. Laugh at it. Or simply hit the gym and sweat it out. After all, staying fit is a luxury not many have!

- Yoga and meditation hall
- Library
- AC Indoor games room
- AC Gym
- AC Home Theatre
- Indoor toddler's zone



Live more: **live inspired**



And how long you have been wishing for all those dreams to come true. To see a twinkle in your wife's beautiful eyes. To get that tight hug from your son. To feel your mother's gentle hands on your forehead.

One prayer! Can make all the difference.

- Space for puja
- Adda zone
- Cafeteria





## Live more: live easy

And friends needn't wait anymore because you got late on the way. Be it at work. Be it for a family function. Be it for chilling out. Be on time. Always.

Shuttle bus service from Southwinds to nearest metro station



## Distance from Southwinds

### SHOPPING CENTRES

WOOD SQUARE - 5 km  
METRO CASH & CARRY - 12km  
SOUTH CITY - 13 km

### HOSPITALS

PEERLESS HOSPITAL - 10.4 km  
RTIIC - 11km  
RUBY - 14 km  
DESUN - 14km  
FORTIS 15km  
SHANKAR NETRALAYA - 11km  
R.K. MISSION - 5 km

### MAJOR STATIONS

KAVI NAZRUL METRO STATION - 8km  
KHUDIRAM METRO STATION - 8km  
SUBHASGRAM STATION - 4km

### EDUCATIONAL INSTITUTES

DINBANDU ANDREWS COLLEGE - 8.5 km  
HERITAGE SCHOOL - 16km  
BD MEMORIAL SCHOOL - 6km  
ASSEMBLY OF GOD CHURCH (TOLLYGUNGE) - 11km  
CALCUTTA INTERNATIONAL SCHOOL - 15km  
DELHI PUBLIC SCHOOL - 15km

### OTHER LANDMARKS

GARIA CROSSING - 8km  
SCIENCE CITY - 17km  
RAJPUR BAZAR - 3km



Live more: **live modern**



Love, Check. Smiles, Check. Togetherness, Check.

A high security infrastructure crafted with intelligence and understanding. At Southwinds, your bag full of happiness is sealed and secured forever.

- General store at your convenience to take care of your daily needs
- 24x7 security
- Gated community with guards
- CCTV surveillance





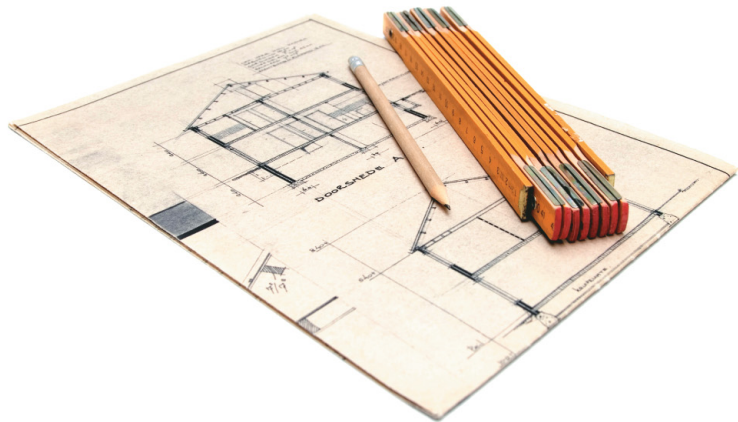

Live more: [live artistic](#)

#### Architect

Agrawal & Agrawal was established in 1986 as a professional architectural firm. Under the leadership of architect JP Agrawal, the firm grew wings pan India and until date has successfully completed 400 projects. We are committed to environment and user friendly architecture. The firm's work has received appreciation and recognition by various esteemed publications and awards. Some of its landmark projects include 'Infinity' , 'Technopolis" , 'Millennium City and 'Forum Mall'.

#### Landscape Consultants

Singal Associates is a Delhi based Landscape Architectural firm established by an internationally experienced Landscape Architect, Krishan C. Singal, qualified from School of Planning and Architecture, New Delhi in 1978. Teaches occasionally at the Department of Landscape Architecture, School of Planning and Architecture, New Delhi. Fellow member of Indian Society of Landscape Architecture. Worked in Middle East for several years.

#### Structural Consultant

ADROIT CONSULTANT, set up in 1999, is an Engineering Consultancy firm specializing in the structural design of all civil engineering applications. Since inception, Adroit has successfully executed the structural design of a host of civil engineering applications, ranging from schools to IT buildings, Malls, Commercial Buildings , residential complex and water reservoirs (Underground & Overhead & Water Treatment Plant.



Srijan Realty Ltd. is a fast-growing real estate company engaged in construction of several projects across East and South India to meet the growing demands of an emergent India. Srijan's landmark residential and commercial projects include Sherwood Estate opposite Ramkrishna Mission- Narendrapur, Heritage Srijan Tower at Kankurgachi, Parkside Residency near Moulali, Trinity Plaza on Park Circus Connector, Srijan Heritage Heights near Rashbehari More, Greenfield City at Behala, Heritage Srijan Park near Park Street, Palazzo near Ballygunge, P.S. Srijan Sonargaon near Garia, Srijan Heritage Enclave at Rajarhat, Srijan Midlands on Jessore Road. It has developed retail space with malls like Galaxy Mall at Asansol and Grand Chennai and modern office buildings like P.S. Srijan Tech Park at Sector-V, PS Srijan Corporate Park at Sector V and Continental at Topsia.

#### Past Project



Sherwood Estate - Narendrapur

#### Glimpses of Sherwood Estate - Narendrapur



#### Ongoing Projects



Greenfield City - Behala



PS - Srijan Corporate Park

#### Other Completed Projects



PS - Srijan Sonargaon - Near Garia

Galaxy Mall - Asansol

Srijan Midlands - Jessore Road

Palazzo - Near Ballygunge

PS - Srijan Tech Park - Sector V



**A diverse and dynamic enterprise committed to elevating the quality of your life**

Our inherent ability to innovate customer solutions helped us venture into textile retail in 1971 with Nand Kishore Pansari at the helm. In 1996, changing preferences of consumer lifestyle encouraged us to diversify into realty. This has been followed by e-retail, distribution and angel investing.

Today, we have 47 lifestyle stores including The Raymond Shop Poddar Court- the master franchisee for the apparel brand and STORY a book lover's paradise across 4 stores in and around Kolkata. We have also brought leisure and recreation through Junction Mall - the biggest mall in Durgapur, South Bengal.

We offer our esteemed customers affordable high fashion with Raymond, Colour Plus, Essence and Esquire. We also offer quality housing with over 18 completed, on-going and upcoming projects.

We have always believed in social upliftment. Through events, and donation drives, we have taken up several initiatives to promote cultural-social interaction and entrepreneurship. This way, we are fast fulfilling our mission of contributing to society and to the environment; making eastern India a better place to live in.

Events at Primarc



Retail Ventures



Story

Master Franchisee - Raymond Ltd.

Esquire

Ongoing Projects



Asitva, Kankurgachi

Aspira

Anukul, Bagmati

Chandannagar Elevation - gangetica

Aura

Primarc Tower, Salt Lake

Completed Projects



Parvati Residency

PGE Plaza

Parvati Garden

Junction Mall, Durgapur

PGE Centre

Prepare to **experience**  
a new **lifestyle.**  
Prepare to **live more.**











भारतीय हरित इमारत परिषद

Indian Green Building Council

A PROJECT BY



Head Office : Primarc Group, 6A Elgin Road, Kolkata-700020  
E southwinds@primarc.in, W www.southwinds.in



Preferred Marketing Agent  
+91 33 4040 1010 sales@nkrealtors.com



