

The Call of the Valley

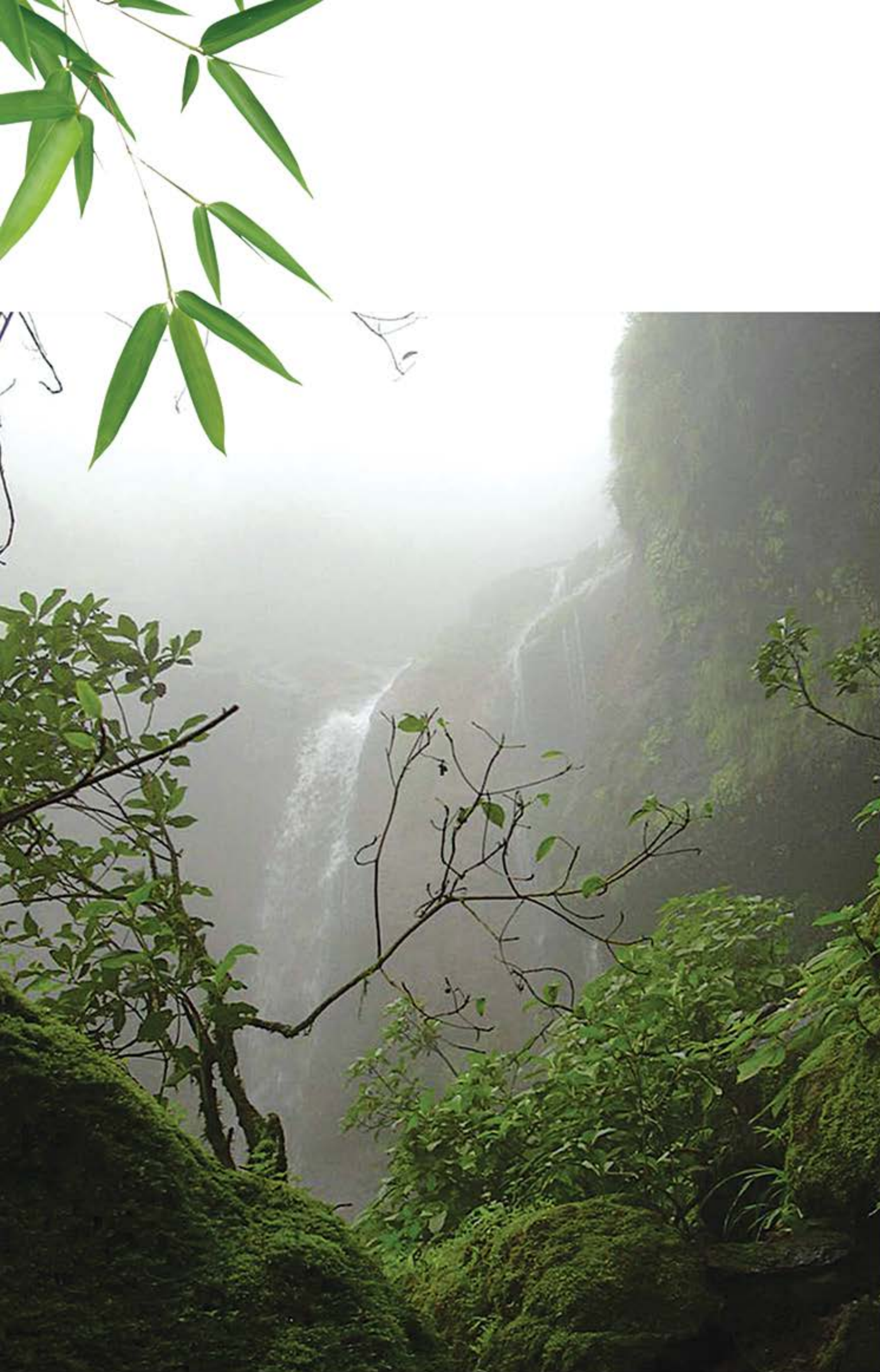



Country roads take me home

It's Friday. The traffic is moving at a snail's pace. Your heart beats a little faster. The week's grind has taken its toll on you. You feel you are just another part of the car's mechanism. Suddenly John Denver is on your car radio, singing "Country roads, Take me home to the place I belong..." and all your stress disappears and you smile. The tensed guy in a suit at the wheels of the car next to yours, looks at you surprised. Wondering about the secret of your smile, in the midst of the jam, noise and chaos of the city.

You smile again. If only he knew. You thank your lucky stars that you have a home in the country. Just the thought of it and your stress makes a hasty retreat. You arrive at your office, cheerful and happy, because tomorrow you and your family will be at your Villa in the woods. Just on the outskirts of Mumbai city.

In **Karjat**, where no matter what the season, nature is fascinating. Nature's bounty, filled with hills, waterfalls and serenity. A place of absolute beauty, where you can hear the sound of the wind, the birds' songs, the rhythm of your own breath.

Location Plan

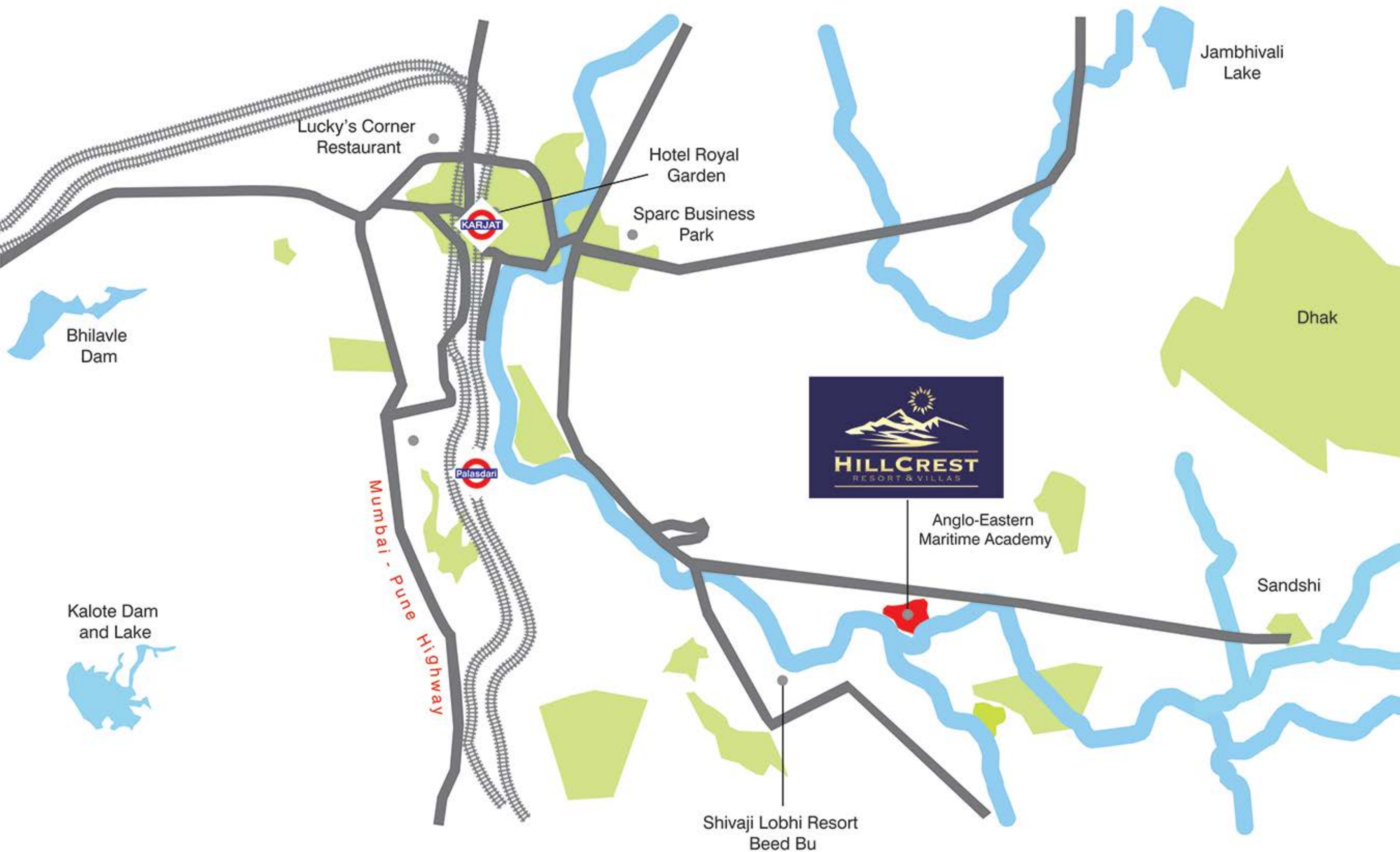

Easy Access

- Karjat will be the next big junction after Panvel
- Nearest Airport to Karjat can be Mumbai as well as Pune
- Well connected by Rail. Local trains go from Mumbai CST to Karjat. It takes 2 hrs and 40 minutes to reach by a slow local.
- By road, Karjat is 100 km from Mumbai
- Accessible via highways like Mumbai-Pune Expressway, NH 17, NH 4.

Layout Plan

- 20 Acres land
 - 19 Villas of 4 BHK
 - 33 Villas of 3 BHK
 - 20 Row Houses of 2 BHK
 - Park Plaza Hotel
- by Carlson Rezidor Hotel Group, USA







Row Houses : 2 BHK
Number of levels : 2 (Ground + First)
No. of Bedrooms : 2
Architecture Style : Modern Contemporary
View from the Villa : Mountains



Row House - 2 BHK

Ground Floor Plan



A	Entrancy Foyer	7'0" X 11'3"	D	Toilet	8'0" X 4'6"
B	Living Room	22'0" X 13'0"	E	Kitchen	12'0" X 8'0"
C	Bedroom	12'0" X 10'9"			

Row House - 2 BHK

First Floor Plan



A	Open Terrace	17'6" X 10'3"
B	Bedroom	12'0" X 17'9"
C	Toilet	12'0" X 6'0"
D	Living Room below	



PERSONAL
GARDEN

Villa Type A : 3 BHK
Number of levels : 2 (Ground + First)
No. of Bedrooms : 3
Architecture Style : Modern Contemporary
View from the Villa : Mountains



Villas Type A – 3 BHK

Ground Floor Plan



A	Living Room	16'3" X 18'6"
B	Dining	11'9" X 10'6"
C	Bedroom 1	14'0" X 11'9"
D	Bathroom	9'2" X 5'0"

E	Servants Toilet	5'10" X 3'11"
F	Kitchen	14'0" X 7'6"
G	Servants Room	9'2" X 4'11"

Villa Type A – 3 BHK

First Floor Plan

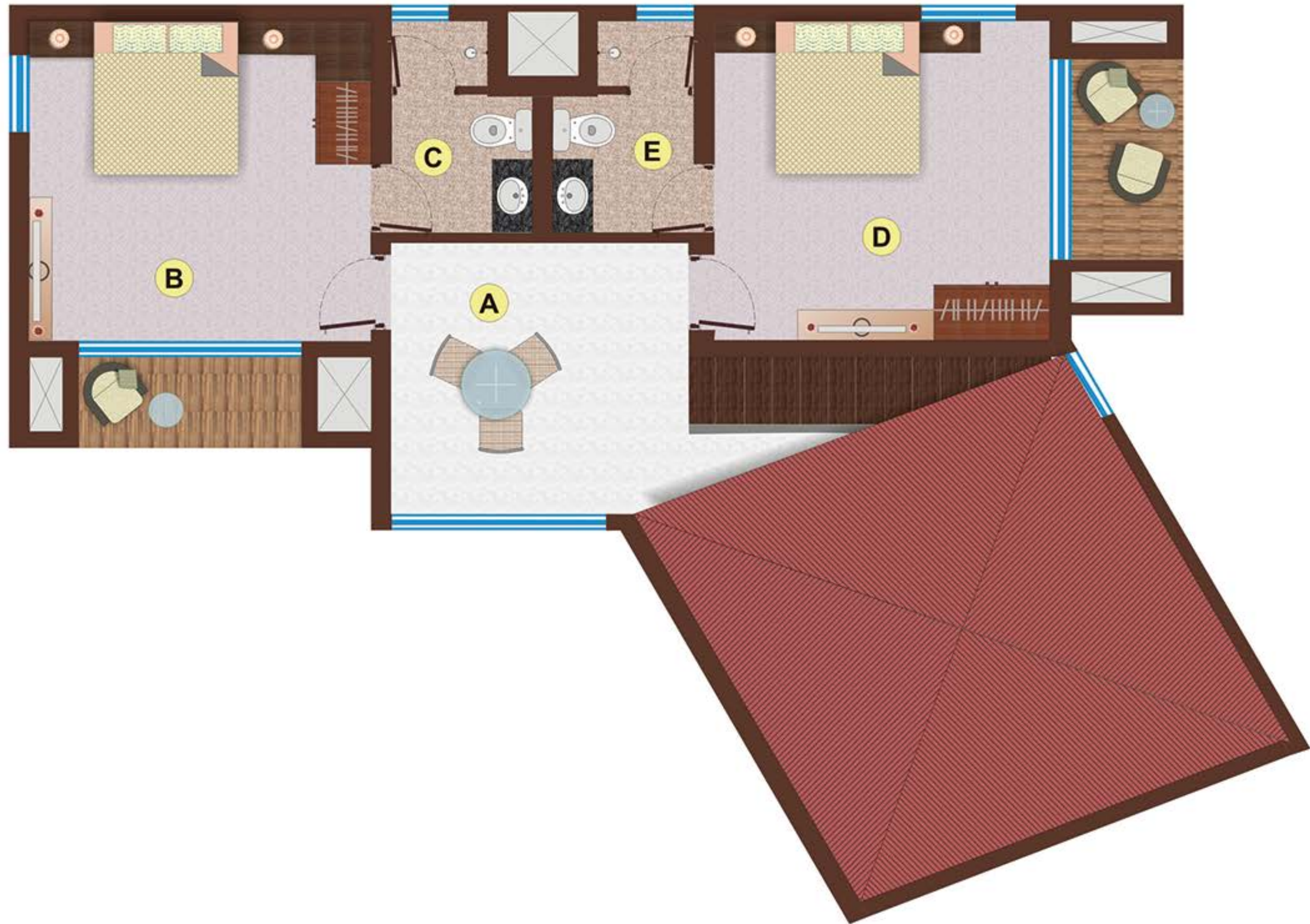

A	Family Sitout	11'9" X 10'6"	D	Bedroom	14'0" X 11'9"
B	Master Bedroom	14'0" X 12'9"	E	Bathroom 3	9'2" X 5'0"
C	Master Bathroom	9'2" X 5'0"			



PERSONAL
GARDEN

Villa Type B : 4 BHK
Number of levels : 2 (Ground + First)
No. of Bedrooms : 4
Architecture Style : Modern Contemporary
View from the Villa : Mountains and River



Villas Type B – 4 BHK

Ground Floor Plan



A	Living Room	14'0" X 18'3"	H	Bathroom 1	9'2" X 6'6"
B	Dining	11'0" X 12'0"	I	Bedroom 2 Passage	4'3" X 6'8"
C	Passage	6'0" X 6'6"	J	Bedroom 2	14'0" X 12'0"
D	Kitchen	9'2" X 9'0"	K	Bathroom 2	9'2" X 6'0"
E	Powder Bathroom	5'10" X 4'6"	L	Servants Room	4'11" X 5'11"
F	Bedroom 1 Passage	4'3" X 7'0"	M	Servants Bathroom	3'0" X 5'11"
G	Bedroom 1	14'0" X 14'0"			

Villa Type B – 4 BHK

First Floor Plan



A	Passage	18'4" X 6'8"	E	Bedroom 4 Passage	4'3" X 7'0"
B	Bedroom 3 Passage	4'3" X 6'8"	F	Bathroom 4	9'2" X 6'6"
C	Bedroom 3	14'0" X 12'0"	G	Bedroom 4	14'0" X 14'0"
D	Bathroom 3	9'2" X 6'2"			



The choice of Italian Marble for floors gives you a bigger picture of all the other amenities of class and quality at Hill Crest. Nothing but the best the world has to offer to match the class of guests we expect. To live up to the standards of people with rich taste and sophisticated lifestyles. Like you.

Internal Amenities Par Excellence

- Superior quality doors & hardware fittings • Aluminum anodized windows
- Black granite kitchen platform & vitrified tiles for dado & flooring • Kohler fittings along with superior quality sanitary ware • Sufficient electric points with concealed copper wiring & reputed make modular switches • Italian marble flooring in living & dining area • Provision for split air-condition for living, dining & bed rooms
- Shower Area with tiles fitted



From parking space that does justice to your precious cars to pampering your eclectic taste for food with multi-cuisine restaurant and cafeteria, each amenity has been thoughtfully planned to appeal to each member of your family. Like the Kids Play Area, a vast area with modern recreational facilities to keep you children healthily occupied and enable them to develop a good appetite.

Fabulous External Amenities

- Ample Parking ● Club House ● Multi-cuisine restaurant & Cafeteria ● House Keeping Facility
- Swimming Pool ● Kids Play Area ● Jogging / Walking Track ● Mini Amphitheatre ● Multi Play Court



Park Plaza Hotel by Carlson Rezidor Hotel Group, USA

Park Plaza hotel, sited on the Ulhas river promises to be an perfect destination for people wishing to escape the pressures of city life in Mumbai and come and relax in the beautiful environs of the Ulhas Valley with its cliffs, streams and wide open landscape.

The aim of this design study is to determine the theme and outline design of the hotel and its landscape setting.











HILL CREST RESORT & SPA

701 Powai Plaza, Hiranandani Gardens, Powai, Mumbai - 400076. (India)

E-mail : hillcrestkarjat@gmail.com **Website :** www.hillcrestkarjat.com

Site Office : Village Kandape, Taluka Karjat, District Raigad, Maharashtra

Disclaimer : The plans, specifications, images and other details herein are only indicative and subject to the approval of the concerned authorities. The Developer/Owner reserves the right to the change any or all of these in interest of the development, without prior notice or obligation. Artist's impressions are used to illustrate the amenities, specifications, images and other details and these may be applicable to select villas only. Tolerance of +/- 2% is possible in the unit areas on account of design and construction variance. All brands stated are subject to final decision of the project architect. This printed material does not constitute an offer and/or contract of any type between the Developer/Owner and the recipient. Any purchase/lessee of this development shall be governed by the terms and conditions of the Agreement for Sale/Lease entered into between the parties, and no detail mentioned.